



Squeegee Switch Harness Connector Retrofit Kit

Models: T300, T300e, Speed Scrub 300, A300



This kit includes the necessary parts to prevent or repair a damaged squeegee switch connector harness.

9016739 Kit Contents

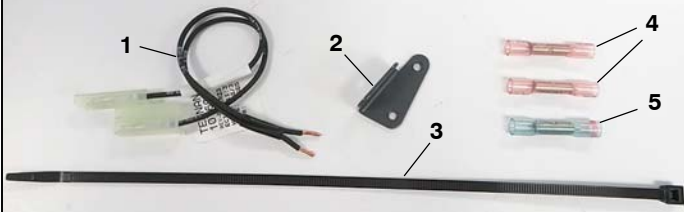

Ref	Part No.	Description	Qty.
1	1076046	Harness, Extension	1
2	1233709	Bracket, Retaining, Wire	1
3	130773	Tie, Cable, Nyl, 11/0L, .14w, 3.0 Max. D	1
4	n/a	20awg Red Butt-Splice Connector	2
5	n/a	18awg/20awg Blue Butt-Splice Reducer Connector	1

INSTALLATION INSTRUCTIONS:

Installation Time: 1 Hour

Tools Required: Phillips screwdriver, wire cutters, wire stripper, insulated terminal crimper and heat gun.

1. Park machine on a level surface and remove key.
2. Disconnect battery cables from battery pack.

FOR SAFETY: Before servicing machine, stop on level surface, turn off machine, remove key and disconnect battery connection.

3. Remove squeegee assembly from machine.
4. Lower the squeegee lift bracket and slide it over to the left to access the squeegee switch.
5. Disconnect the wire harness connector from the squeegee switch.

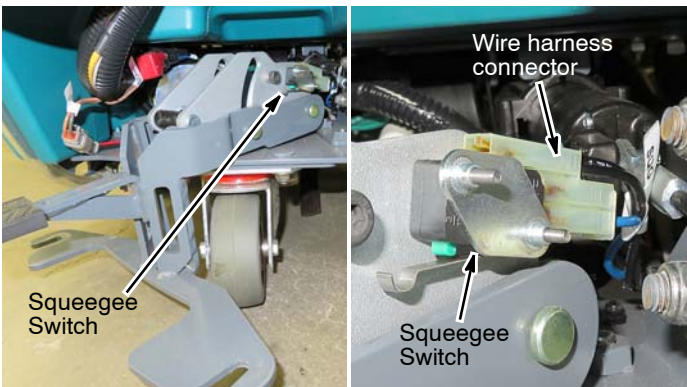

6. Cut wires close to connector and strip as shown.

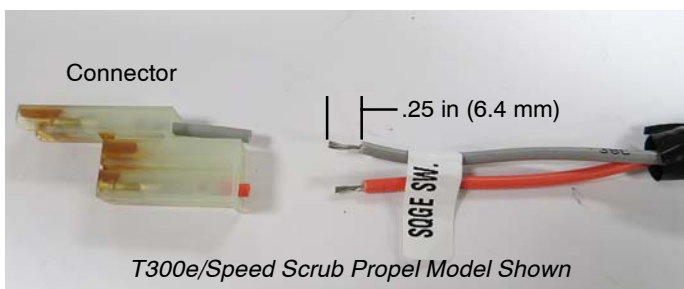

7. Connect the extension harness to the cut wires using butt-splices as shown per model type.

NOTICE: ONLY use an insulated terminal crimper to prevent terminal damage.

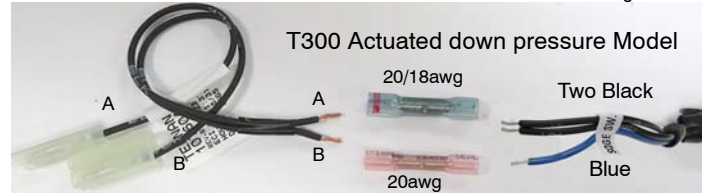
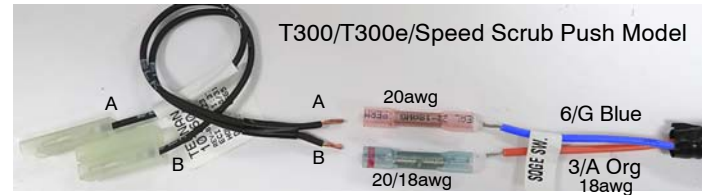
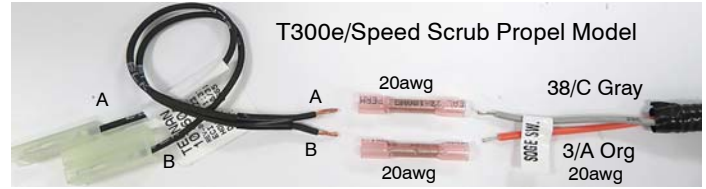

8. Lightly pull the wires to ensure crimps are secure. Apply heat to the butt-splices to seal connection.
9. Install the harness retaining bracket using existing switch screws as shown. Do not over tighten screws.

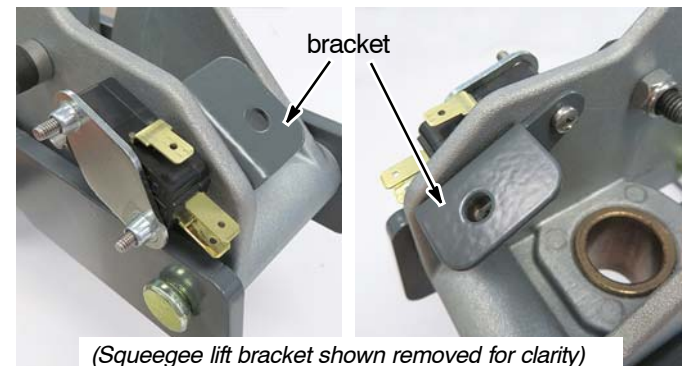

10. Loop the harness as shown and secure with cable-tie. Ensure harness does not bind when moving squeegee bracket its full range. Also check for actuator clearance for models equipped actuated down pressure.

